

VWT5 Furniture

Construction plans and material lists



: *Tim Kägy*



: *tim_kaegy*

Content

Content.....	2
Introduction	3
1. Division	4
2. Kitchen.....	6
2.1 Sketches.....	6
2.2 Material list	7
2.3 Wood cuts	8
3. Wardrobe	10
3.1 Sketches.....	10
2.2 Material list.....	12
2.3 Wood cuts.....	13
4. Bed.....	15
4.1 Sketches	15
4.2 Material list.....	17
4.3 Wood cuts	17
5. Shore power	18
5.1 Material list	18
6. Others.....	19
6.1 Material list.....	19
Closing word	20

Introduction

Hey - I'm really happy that you like my bus conversion! I hope I can help you converting your bus with the following plans and material lists and save you a lot of time and work! If you have any further questions that are not yet answered by these plans, please write me again on Instagram or via email. I am happy if I can help you! :)

Before you get started, a little disclaimer: These are certainly not detailed instructions on how to recreate the furniture 1: 1, but rather a processing of the construction plans and order lists from my expansion, which should serve as an orientation and source of inspiration. But I tried to document everything as detailed and neatly as possible! - For clarification purposes I will refer here and there to certain timestamps in my YouTube videos :)

Approach

At the beginning I would like to give you a little learning from my first conversion. At that time I had a rough idea of what the bus might look like later - but most of it actually came about during the construction itself. So I built compartments and looked to see what could fit into them afterwards. As a result, I wasted a lot of space and often had a mess on the bus.

Before I planned the exact division of the furniture for my second expansion, I first considered which items I would later have in my bus. For all these objects I created placeholders from the beginning and included them directly into the furniture planning. That was one of the most important things that I learned from my first expansion: **Every object needs to have its fixed place in the van!**

Here you can see examples of a few placeholders for the items for which I have built extra compartments so that they will have a permanent place in the van.

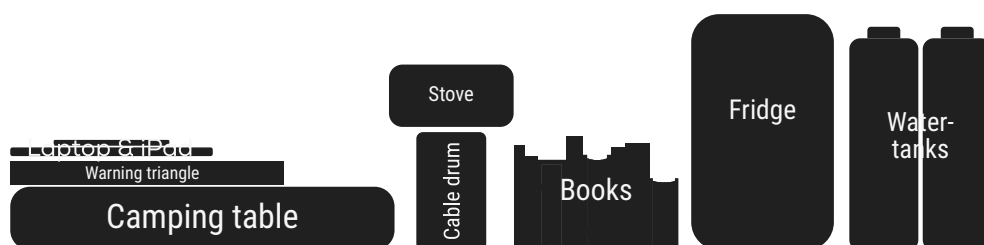

But I also planned fixed places in the bus for smaller items such as clothes, groceries and hygiene items from the start.

1. Division

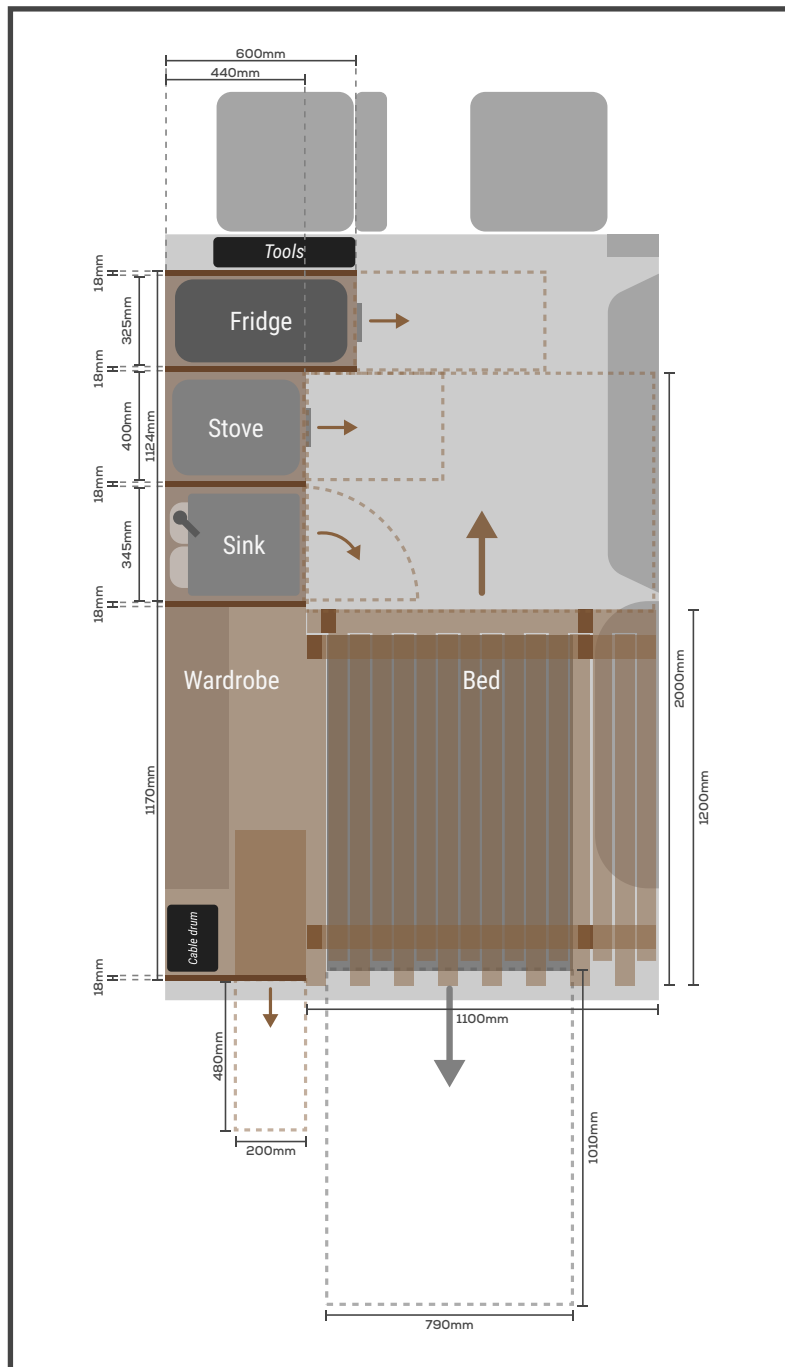

Illus.1: General layout and external dimensions of the furniture from above. The dashed shapes represent pull-outs or cabinet doors.

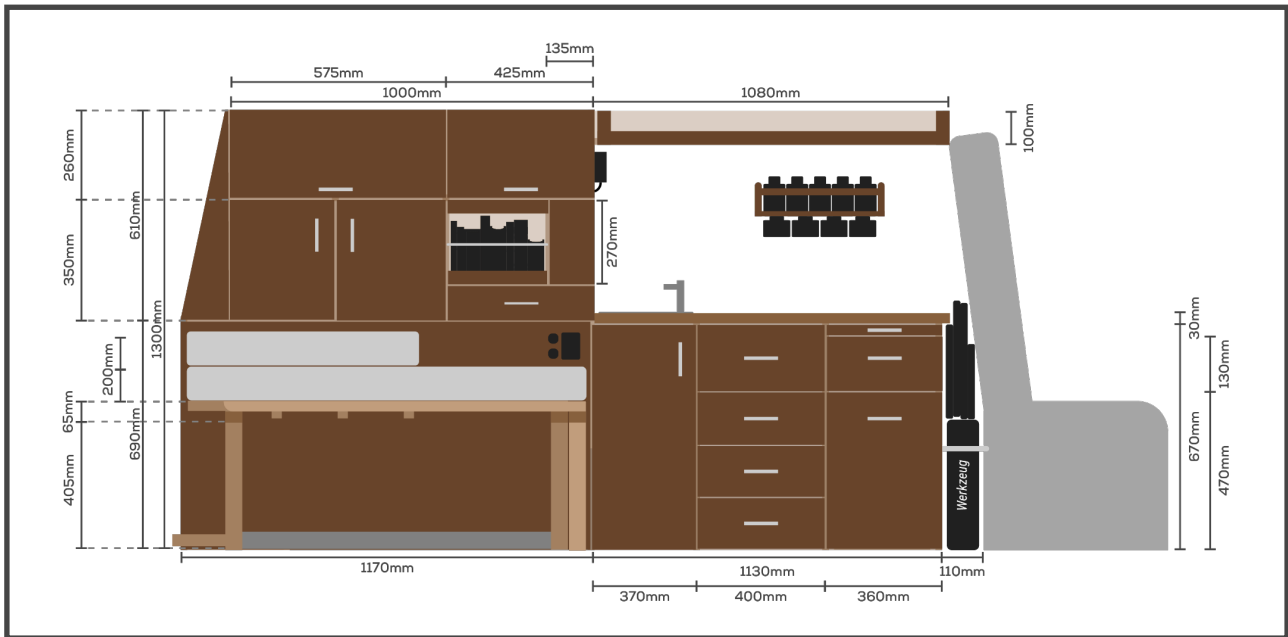

Illus.2: General layout and external dimensions of the furniture (or the furniture fronts) from the perspective of the sliding door (on the right in the direction of travel).

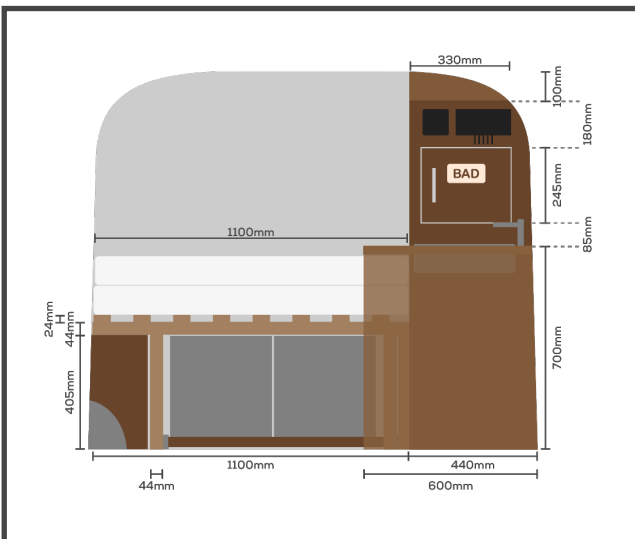

Illus.3: General layout and external dimensions of the furniture from the perspective of the driver's seat to the rear.

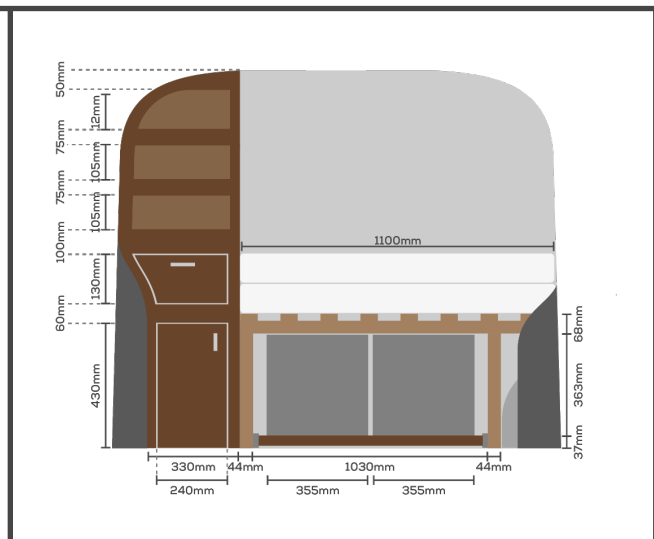

Illus.4: General layout and external dimensions of the furniture from the rear, through the tailgate..

In the next chapters I will go into more detail about the individual pieces of furniture (kitchen, side cabinet & bed). After each, precisely dimensioned sketch, you will find a small list with the materials used for the respective piece of furniture. I have also listed all the wood panels that I have used and made sketches of how I cut the respective wood panels!

2. Kitchen

2.1 Sketches

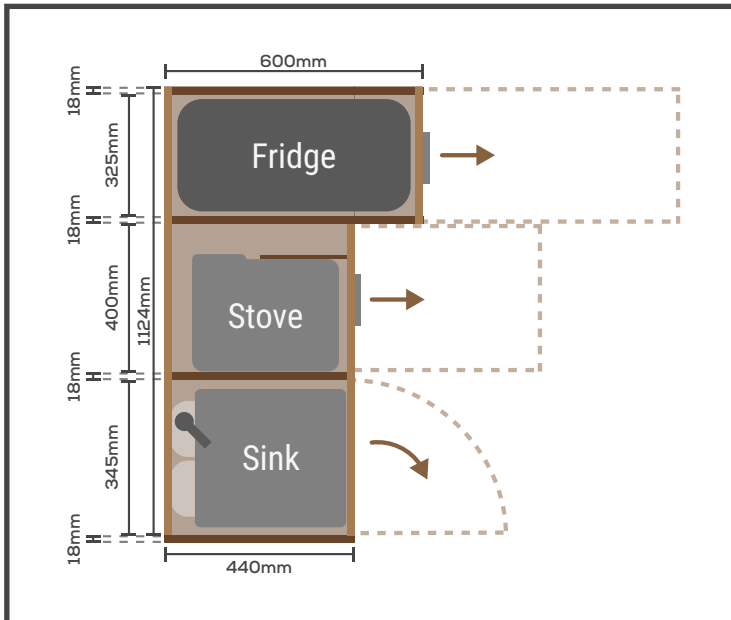

Note to the sketch

The dark, horizontal rectangles represent 18mm thick multiplex panels. The lighter, vertical rectangles represent slats that connect and stabilize the multiplex panels.

For better visualization:

<https://youtu.be/BixFxdGmDM0?t=21>

Illus.5: Distribution of the kitchen furniture from the top view. The dashed lines represent pull-outs or cabinet doors.

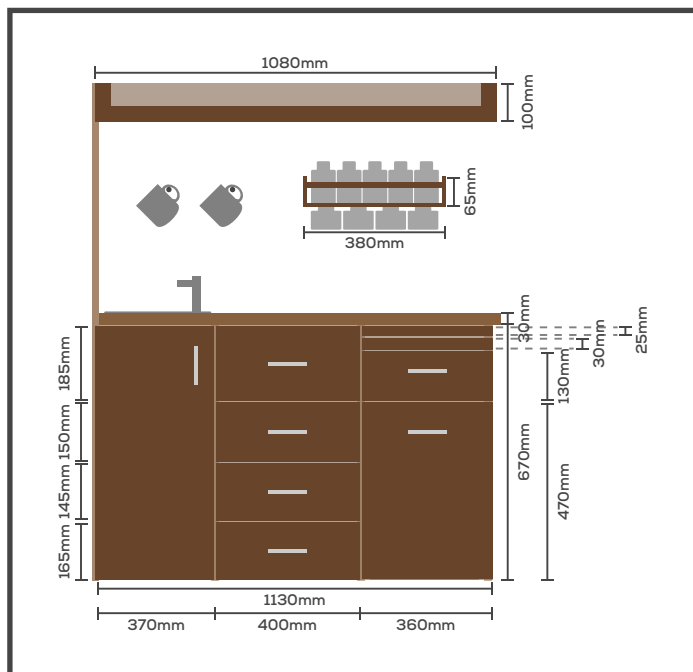

Illus.6: Division of the kitchen fronts from the perspective of the sliding door.

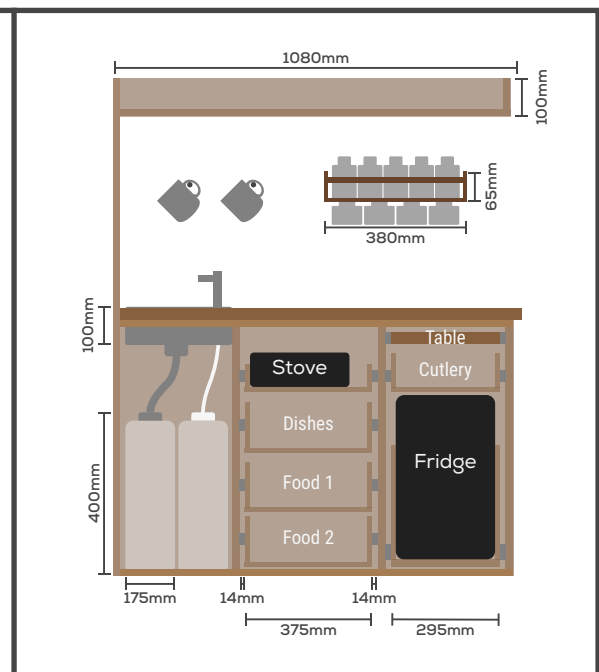

Illus.7: Division of the kitchen furniture without fronts from the perspective of the sliding door.

I built the sink from a standardized GN 2/3 container. - Is a lot cheaper than a camping sink, but works just as well!

For better visualization:

<https://youtu.be/BixFxdGmDM0?t=227>

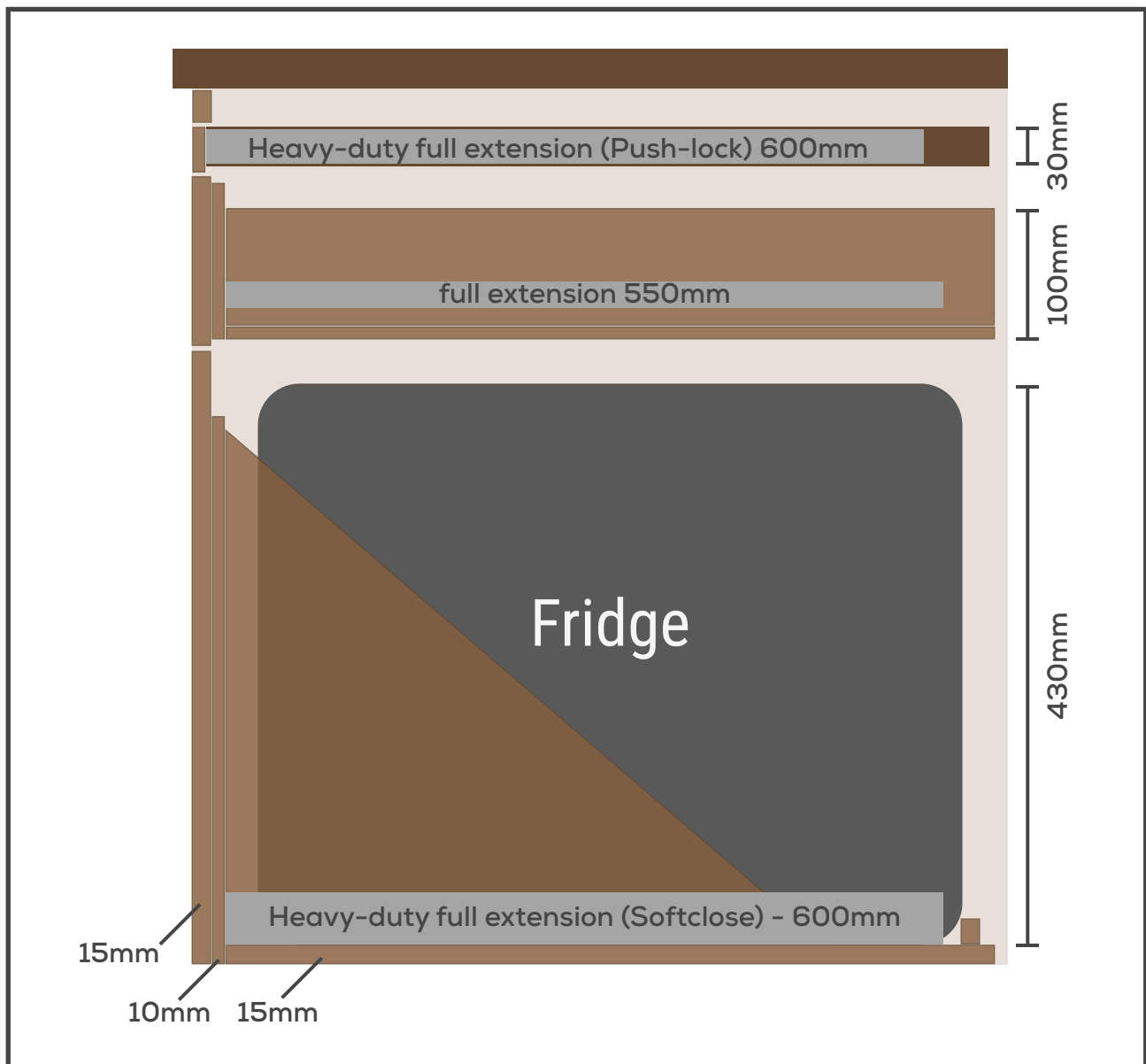

Illus.8: Side view of the refrigerator pull-out, the cutlery drawer and the extendable table.

2.2 Material list

Items	Link	Number	Price / piece	Total
Tabletop 1600x800x26mm (for all tables)	https://www.hornbach.de/shop/Tischplatte-Eiche-B-C-geoeilt-1600x800x26-mm/B203402/artikel.html	1	103,80 €	103,80 €
Full extension (Fridge)	https://amzn.to/3Btisbf	1	18,90 €	18,90 €
Full extension (Table)	https://amzn.to/3jBpVfU	1	18,59 €	18,59 €
Pull-out drawer (long)	https://amzn.to/2UHDwdo	1	17,73 €	17,73 €
Drawers (short)	https://amzn.to/3BviQ2W	4	15,61 €	62,44 €

Items	Link	Number	Price / piece	Total
Dometic CoolFreeze CDF 26	https://amzn.to/3zw6ZWN	1	428,99 €	428,99 €
Camping stove	https://amzn.to/3Am40x	1	53,58 €	53,58 €
Sink	https://amzn.to/36Uwkc	1	12,40 €	12,40 €
Water tap	https://www.fritz-berger.at	1	24,99 €	24,99 €
Submersible pump	https://amzn.to/3hXE7RI	1	15,87 €	15,87 €
Water tanks	https://www.obelink.de/killian-din-96-kanister.htm?content_axis=19	2	14,95 €	29,90 €
LED strips	https://amzn.to/3kLplJN	3	4,75 €	14,25 €
Total:				801,44 €

2.3 Wood cuts

I bought all of my wood from a regional timber trade. This offers multiplex, plywood, screen printing and OSB3 panels in fixed, large and individually cut in all possible thicknesses. As far as I know, the timber trade also delivers across Europe. Maybe there is something for you too:

<https://rombs-gmbh.de/plattenware/?p=1>

In the following table you can see my wood order for the kitchen. The prices were based on the regional timber trade. I would choose the same strengths of the wood in the kitchen again at any time.

Nr.	Wooden panel	Dimensions	Number	Price / piece	Total
10mm plywood					
1	Drawer side	850mm x 550mm	1	11,22 €	11,22 €
2	Drawer - long	680mm x 550mm	1	8,98 €	8,98 €
3	Drawer bottom & back	1400mm x 550mm	1	18,48 €	18,48 €
4	Drawers front	760mm x 670mm	1	10,12 €	10,12 €
5	Fronts - kitchen	1050mm x 670mm	1	16,88 €	16,88 €
6	Wall cabinet - panel	1075mm x 115mm	1	2,97 €	2,97 €
15mm plywood					
7	Fridge plate	600mm x 300mm	1	6,30 €	6,30 €
8	Fridge side	310mm x 550mm	1	4,09 €	4,09 €
18mm plywood					
9	Kitchen walls - long	670mm x 600mm	2	16,08 €	32,16 €

Nr.	Wooden panel	Dimensions	Number	Price / piece	Total
10	Kitchen walls - short	670mm x 450mm	1	12,06 €	12,06 €
11	Wall cabinet - floor	1050mm x 330mm	1	17,31 €	17,31 €
Total:					140,57 €

Some of the panels still have to be cut to size in order to be able to use them. On the next page I sketched how I sawed the plywood panels listed above.

The panels that were not sketched either did not have to be cut to size or only had to be adapted to the shape of the bus.

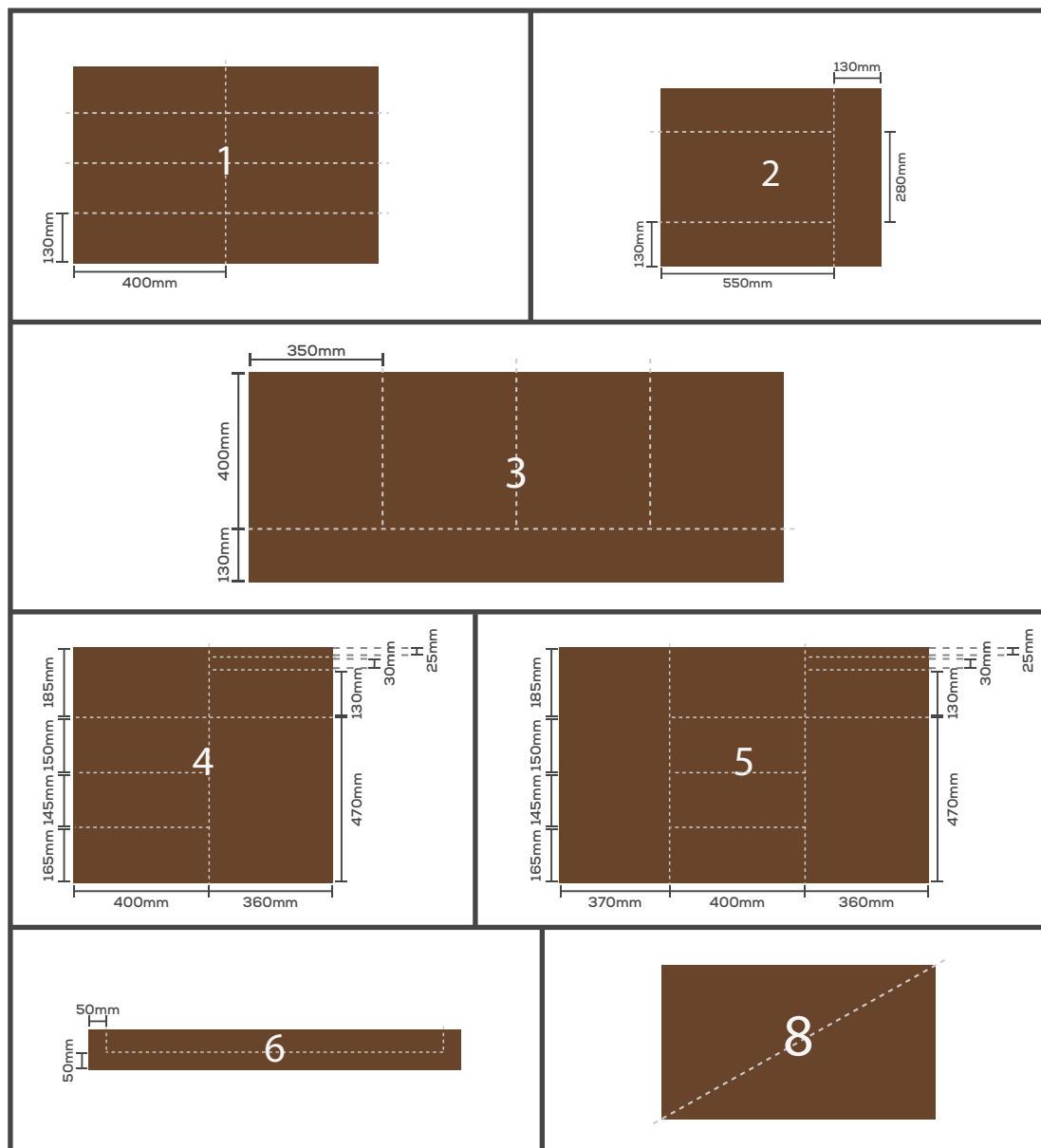

Illus.9: Cut to size for the construction of the kitchen

If you want to see in more detail how I built the interior elements of the cabinet without using a single angle, take a look at the corresponding section in the video again:

<https://youtu.be/BixFxdGmDM0?t=93>

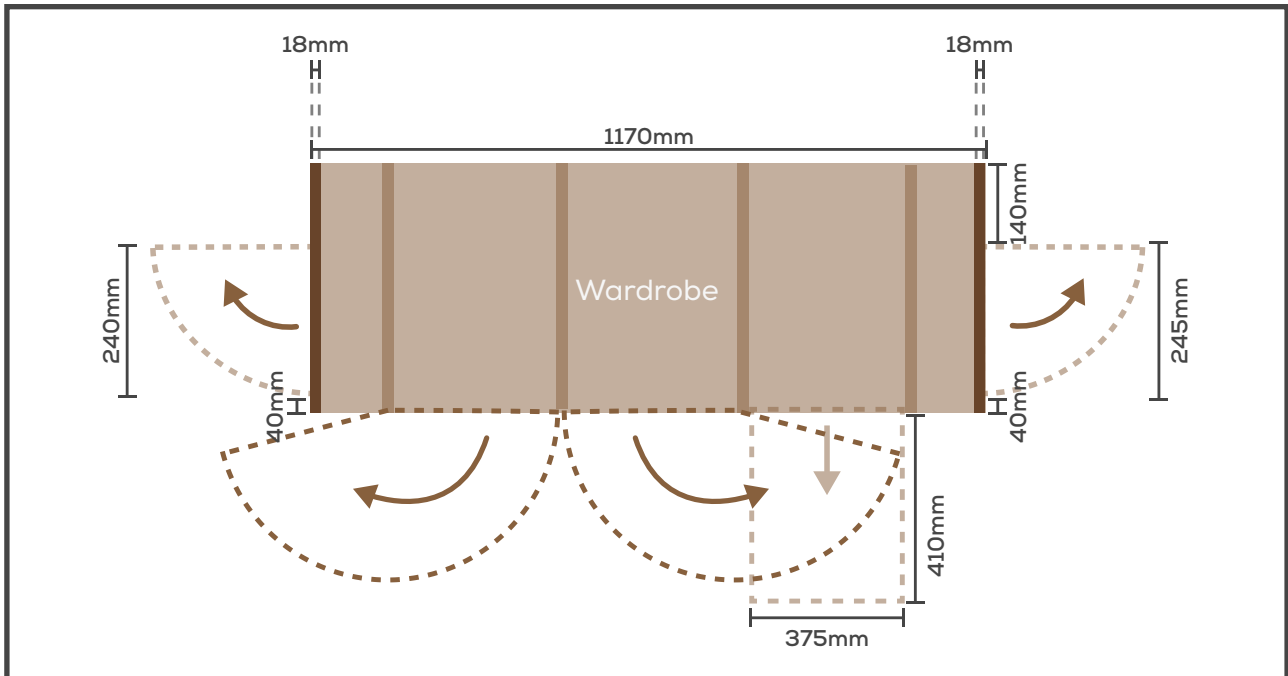

Illus.12: Top view of the side cabinet. The dashed lines represent cabinet doors or drawers.

Notes on the sketch:

I installed my bathroom behind the door on the right. I installed small rubber hangers and a small mirror on the door.

For better visualization:

https://youtu.be/OMZJ_nouXD0?t=308

With the cabinet doors of the side cabinet, it was particularly important to me that I could still open them fully from the outside, so I installed 160 ° hinges instead of the usual 90 ° hinges.

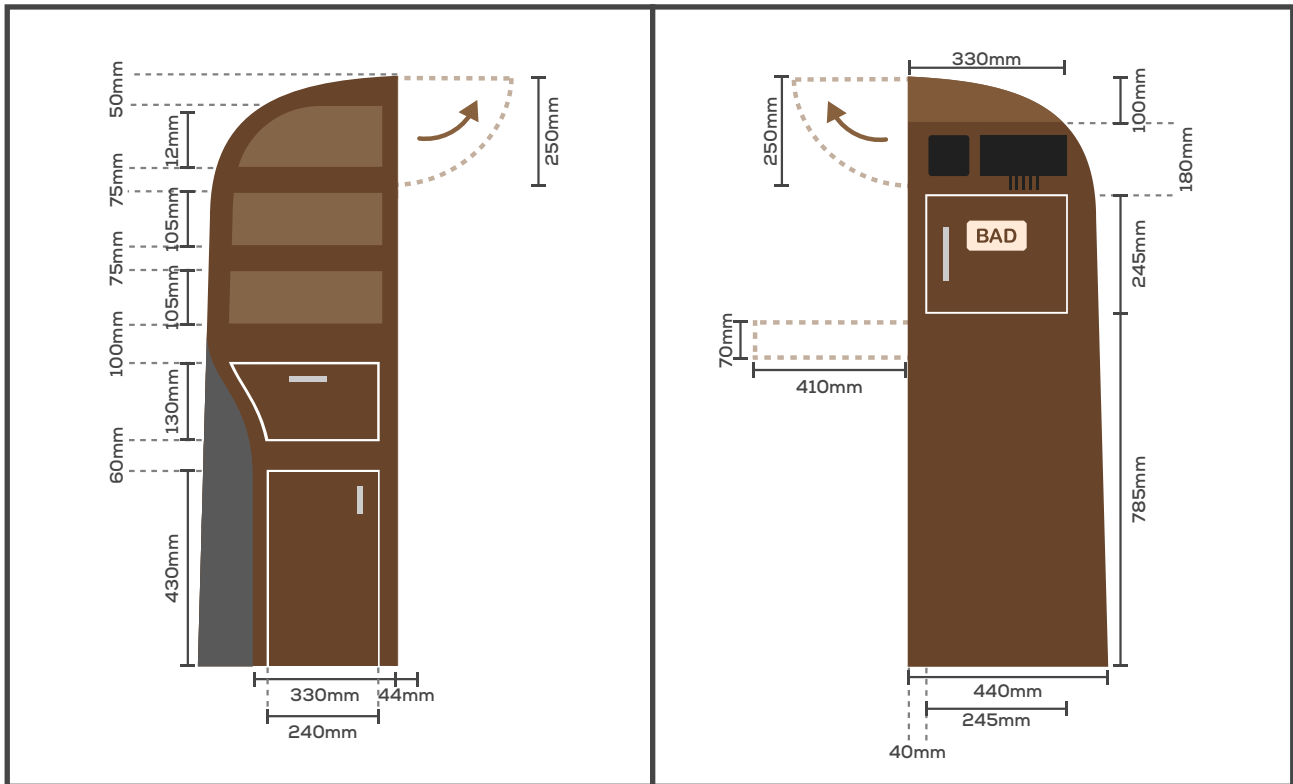

Illus.13: Aufteilung und Außenmaße des Seitenschanks von hinten, durch die Heckklappe.

Illus.14: Aufteilung und Außenmaße des Seitenschanks aus Sicht des Fahrersitzes nach hinten.

2.2 Material list

Item	Link	Number	Price / piece	Total
Extension laptop drawer	https://amzn.to/3eLgQQw	1	15,48 €	15,48 €
Extension table	https://amzn.to/3eLgQQw	1	15,48 €	15,48 €
165 degree hinge	https://amzn.to/3eLCiVq	1	19,39 €	19,39 €
Gas springs	https://amzn.to/3BvmSye	1	13,99 €	13,99 €
Aluminum switch panel	https://amzn.to/3BoFNe6	1	9,99 €	9,99 €
Solar charge controller	https://amzn.to/3kN85cf	1	65,00 €	65,00 €
Cable drum	https://amzn.to/3eMvjeW	1	31,99 €	31,99 €
Gesamt:				171,32 €

2.3 Wood cuts

Nr.	Wooden panel	Dimensions	Number	Price / piece	total
10mm Plywood					
1	Drawer cabinet	490mm x 450mm	1	5,29 €	5,29 €
15mm Plywood					
2	Front between wardrobe and bed	1200mm x 700mm	1	29,40 €	29,40 €
3	Cabinet doors & fronts	1200mm x 700mm	1	20,16 €	20,16 €
4	Triangle front	170mm x 610mm	1	3,04 €	3,04 €
18mm Plywood					
5	Wardrobe - outside	1400mm x 450mm	2	25,20 €	50,40 €
6	Wardrobe - inside vertical	700mm x 450mm	2	12,60 €	25,20 €
7	Wardrobe - inside horizontal	1200mm x 450mm	3	21,60 €	64,80 €
8	Wardrobe - bathroom etc.	1000mm x 450mm	1	18,00 €	18,00 €
	Total				216,29 €

Notes on ordering wood for the cabinet:

With No. 6, 7 & 8, i.e. the upper inner elements of the side cabinet, you can definitely use thinner wood and save some weight. The 18mm thick plates are not necessary here.

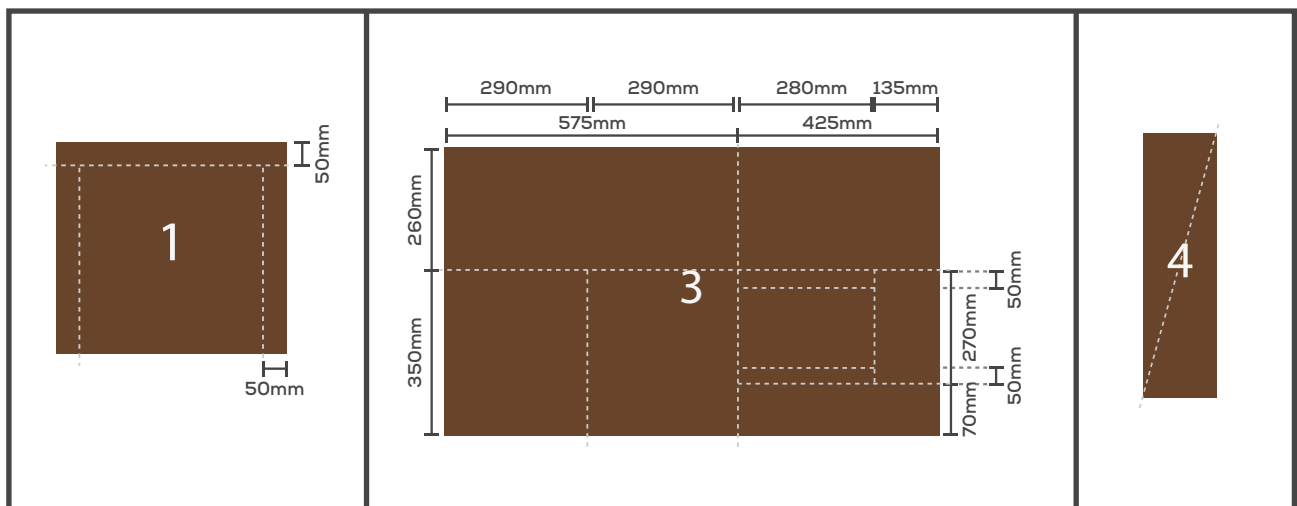

Illus.15: Cut to size for the construction of the side cabinet.

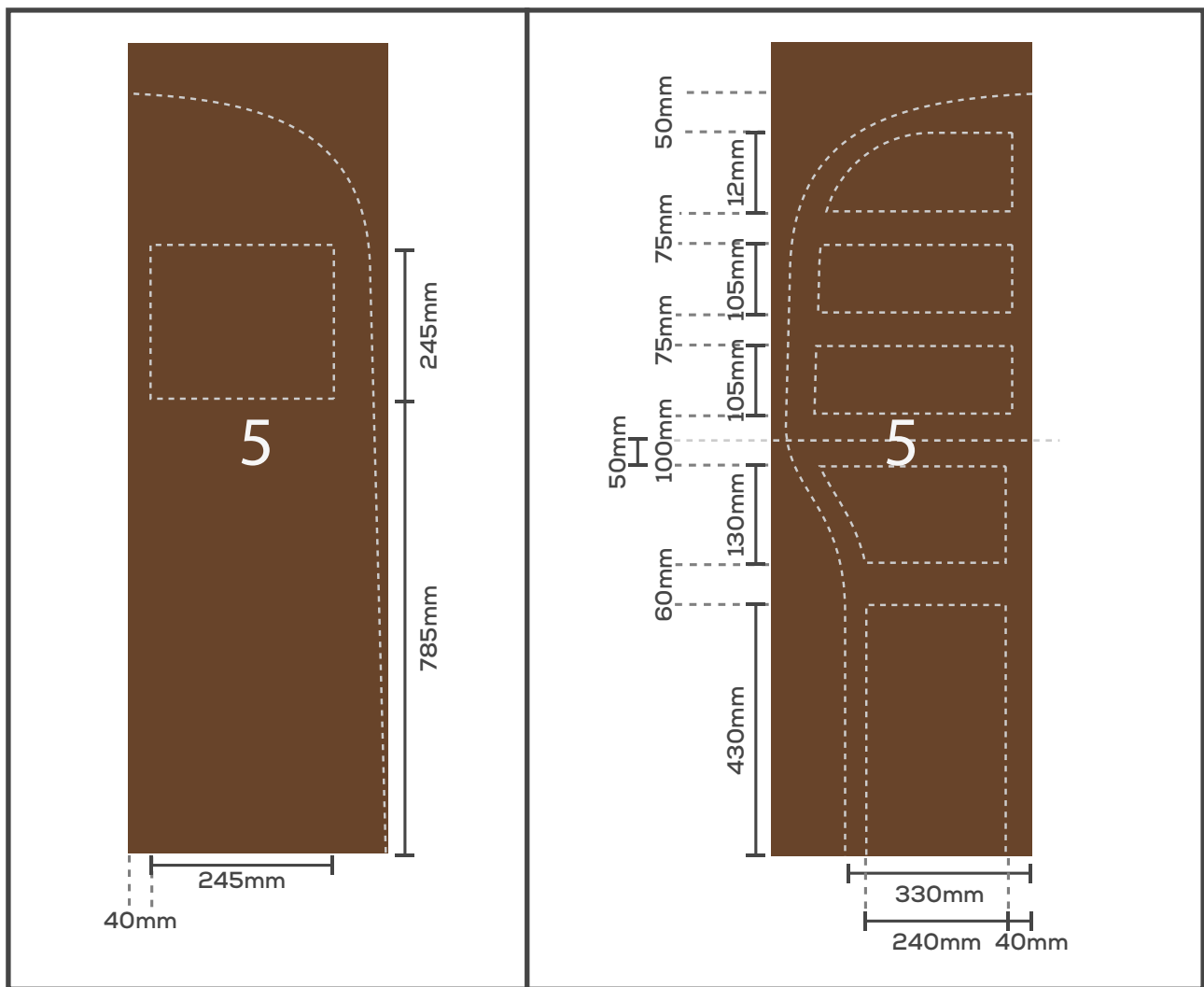

Illus.15: Cut to size for the construction of the side cabinet.

4. Bed

4.1 Sketches

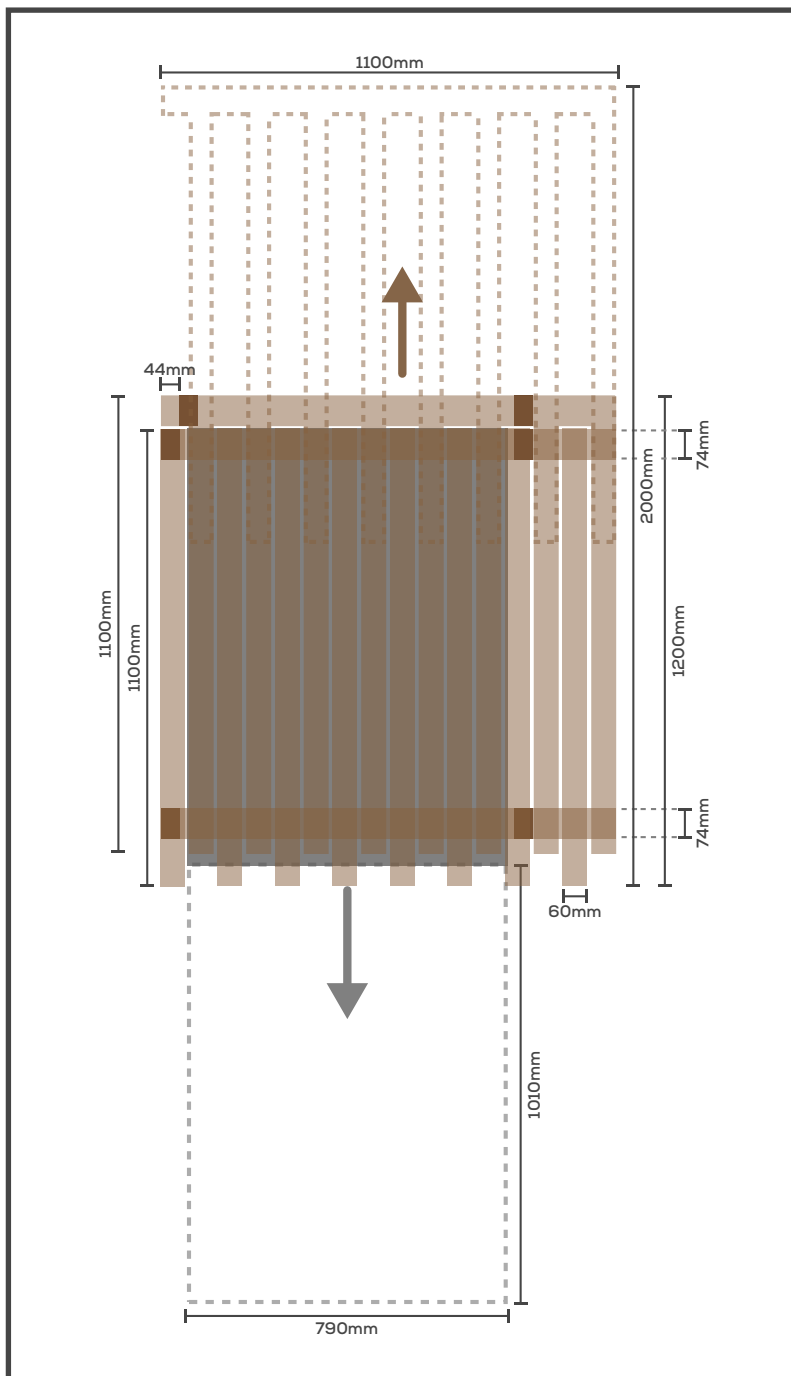

Illus.16: Structure and dimensions of the bed from the top view.

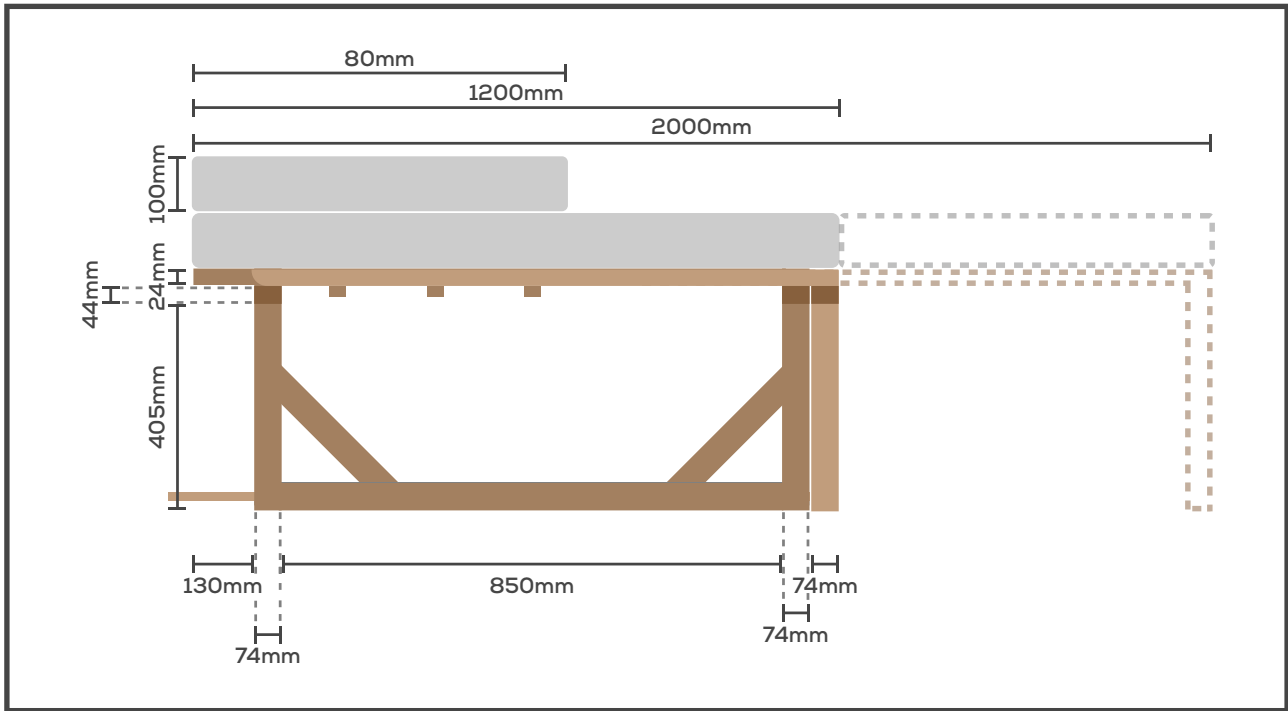

Illus.17: Structure and dimensions of the bed from the perspective of the sliding door (right direction of travel).

The 3 cross struts under the slatted frame serve as a guide for the pull-out part. Due to the transverse bars, it cannot fall down and remains at the same height. The left ends of the extendable part are rounded so that they do not get caught on the cross braces.

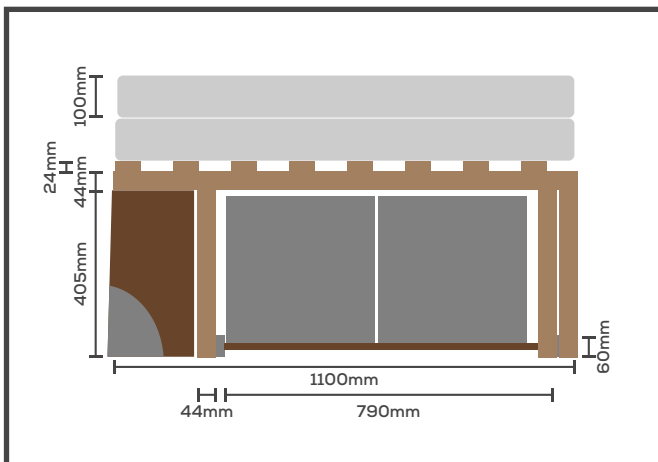

Illus.18: Structure and dimensions of the bed as seen from the driver's seat to the rear.

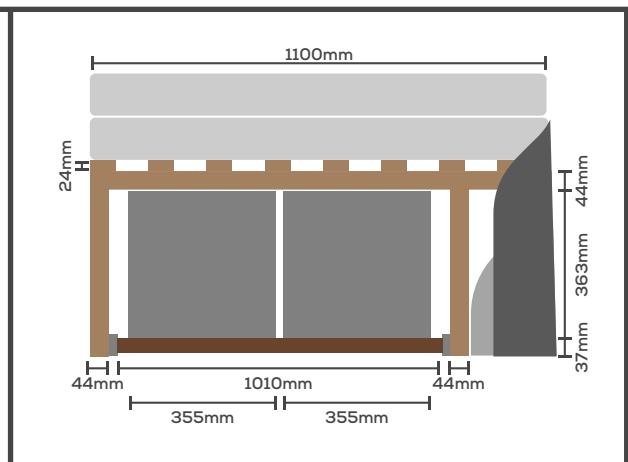

Illus.19: Structure and dimensions of the bed from behind, through the tailgate.

The two front bars in the picture on the left in Figure 16 are offset so that the front supports do not get caught on the handles of the kitchen when they are pulled out. So that they slide easily over the floor, I covered the feet with firs.

4.2 Material list

Item	Link	Number	Price / piece	Total
Fabric for covers	https://www.stoffundstil.de/stoffe/moebelstoffe/moebelstruktur/moebelstruktur-hellgrau-5?RaptorItemClick=True	4	14,00 €	56,00 €
Mattress	https://www.ikea.com/at/de/p/moshult-schaummatratze-fest-weiss-80272327/	1	99,00 €	99,00 €
Bars (bed frame)	https://www.hornbach.de/shop/Kanholz-44x74x2500-mm-Fichte-gehobelt/1000266/artikel.html	7	3,24 €	22,68 €
Rear extension	https://amzn.to/3kGJUMQ	1	105,76 €	105,76 €
Aluminum angle profile (for rear pull-out)	https://www.hornbach.at/shop/Winkelprofil-Aluminium-silber-40x40x2-mm-2-m/6069587/artikel.html	1	16,95 €	16,95 €
Boxes (under bed) *	https://kisten-online.de/product/sitzkiste-sissi-natur-schwarze-auflage/	1	24,99 €	24,99 €
				0,00 €
				0,00 €
				0,00 €
Total:				325,38 €

* In order for the boxes to fit exactly under the bed, I had to saw off the top board. For the dark look, I finished the boxes with walnut wood glaze.

4.3 Wood cuts

Nr.	Wooden panel	Measure	Number	Price / piece	Total
15mm Plywood					
1	Pull-out plate	1010mm x 790mm	1	31,92 €	31,92 €
24mm Plywood					
2	Slatted frame	1100mm x 60mm	16	3,23 €	51,68 €
	Total				83,60 €

5. Shore power

I simply got my shore power via two battery chargers and a multiple socket. I proceeded as follows:

The outdoor socket strip is in the motorcycle by the starter battery. The cable of the socket strip later serves as the cable, which can be connected to the shore power with an extension cable. At the end I put the personal protection adapter to secure the whole thing. One of the two chargers is now connected to one of the two sockets, which can now charge the starter battery. In the other socket is the 3-way socket strip, which I put through the cable duct to the engine compartment, under the floor mat and under the driver's seat. To get the cable through the cable gland, you have to cut the plug and attach the protective contact plug after passing it through. The second battery charger is now charging my second battery under the driver's seat. The other two sockets can be used normally as soon as the shore power is connected.

Here I once again briefly explained how shore power works (In German though):

https://youtu.be/OMZJ_nouXD0?t=65

5.1 Material list

Item	Link	Number	Price / Piece	Total
3-way power strip	https://amzn.to/3zEGZIT	1	4,49 €	4,49 €
Safety plug	https://amzn.to/3eIO6ba	1	9,29 €	9,29 €
Outdoor power strip	https://amzn.to/3eI5IsP	1	10,99 €	10,99 €
Protection adapter	https://amzn.to/3Bw8Ht2	1	14,95 €	14,95 €
Battery charger	https://amzn.to/3BtinRf	2	42,45 €	84,90 €
				0,00 €
				0,00 €
Total:				124,62 €

6. Others

6.1 Material list

Item	Link	Number	Price / Piece	Total
Swivel bracket (passenger)	https://www.kiravans.de/products/european-vw-t5-t6-passenger-side-seat-swivel-rib-lhd	1	187,99 €	187,99 €
Curtain sliding door	https://www.kiravans.de/products/vw-t5-t6-curtain-kit-grey-right-centre-sliding-door	1	33,99 €	33,99 €
Curtain tailgate	https://www.kiravans.de/products/vw-t5-t6-curtain-kit-grey-tailgate-door	1	35,99 €	35,99 €
Camping table	https://amzn.to/3BzbNMD	1	79,95 €	79,95 €
Camping chair	https://amzn.to/3kMdbWg	2	100,00 €	200,00 €
				0,00 €
				0,00 €
				0,00 €
				0,00 €
				0,00 €
Total:				537,92 €

Closing word

I very much hope that the plans and lists were able to help you with your bus project and that I could possibly save you a lot of work! As already written above, you are welcome to contact me at any time if you have further questions! - Maybe we'll also meet on-tour some time!

I made the plans available for free on purpose, because I want to help as many people as possible with their bus project and so everyone can decide for themselves how much the plans are worth to them. So if the plans have helped you, you are very welcome to support me with a small donation on my further trips! I would be glad!

Kind regards and always have a good trip!

Tim Kägy

paypal.me/timkaegy

